



# TOP-BOX RACK

Thank you for purchasing our VENTURA PRODUCT.  
Before use please read all instructions and our Limited Warranty carefully.

## TBR30/B – Top-Box Rack Adjustable

### FITTING KIT CONTENTS

4 x M8 x 16 Allenhead bolts	2 x M8 x 25 Buttonhead bolts
2 x M8 x 35 CSK Socket head bolts	4 x M8 x 22 x 3 Flat Washers
2 x M8 x 17 x 1.4 Flat Washers	2 x M8 Nyloc nuts
2 x F0863 Mounting Legs	2 x F0864 Mounting Plates
2 x F0865 Tapered Inserts	2 x F0866 Extension Spacers
2 x F0867 Base Plates	

### FITTING INSTRUCTIONS

The TBR30/B top-box mounting can be assembled in two variants to suit the desired height of the rack for your model motorcycle.

Always assemble in the lowest position, being careful to check that in this position it does not interfere with bodywork or seat etc. if it does, assemble in the higher position as described in the instructions below.

1. Assemble the legs to the base plate, as in diagram #1.

### Diagram #1

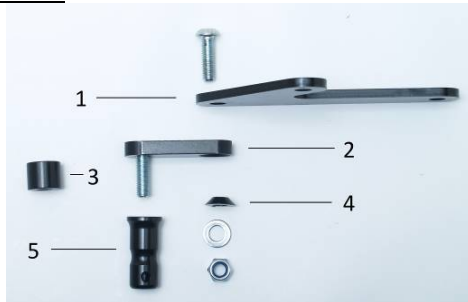

### Legend to Diagram #1

- (1) F0867 Base Plate
- (2) F0864 Mounting plate
- (3) F0866 Extension Spacers
- (4) F0865 Tapered Inserts
- (5) F0863 Mounting Leg

2. Bolt the mounting legs to the mounting plates using the M8 x 35 CSK socket head bolts, use your L-Bracket locking key, by inserting into the hole in the base of the leg to hold the leg, and tighten securely.
3. Bolt the mounting plates to the base plates using the M8 x 25 button head bolts, secure underneath using the tapered inserts, M8 flat washers and M8 nyloc nuts.
4. Position the base plates under the top box mounting plate as in Diagram #2 and secure with the M8 x 16

allenhead bolts and M8 x 22 x 3 flat washers through the top box mounting plate and tighten securely.

### Diagram #2



5. To assemble the TBR30/B in the highest position remove the mounting leg, insert the extension spacer shown in diagram #1, and reuse the M8 x 35 CSK socket head bolt and tighten securely, as in instruction #2.

### LIMITED WARRANTY

**NOTE: Some jurisdictions do not allow limitations on how long an implied warranty, if any, lasts, and do not allow the exclusion of limitation of incidental or consequential damages so the limitations and exclusions below may not apply to you. This warranty gives specific legal rights, you may have other rights which vary from jurisdiction to jurisdiction.**

Dold Industries Limited ("Dold") warrants this product to be free from defects in materials and workmanship under normal use and maintenance for a period of one year from its date of original purchase. Dold shall, at its option, either repair or replace a defective product returned to it or its authorised agents, freight prepaid.

**This warranty does not apply to any product which has been altered, damaged or rendered non-functional through improper installation or maintenance, abnormal wear and tear due to exposure to the elements, negligence, abuse, accidents or any like circumstance.**

**Dold shall not be liable for any incidental nor consequential loss or damage resulting directly or indirectly from any defective product, its sole obligation being to repair or replace such defective product.**

This warranty is in lieu of, and excludes, all other warranties, expressed or implied, including the warranties of merchantability and of fitness for a particular purpose.

To make a warranty claim return the product to the dealer who supplied it with evidence of date of purchase. If you are not satisfied with their response, please contact the distributors for your country or: Dold Industries Ltd, 128-134 Maui Street, P O Box 10-393, Hamilton, New Zealand. Telephone +64 (7) 849-4392. Facsimile +64 (7) 849-4114.

**E-mail: [dold@ventura-bike.com](mailto:dold@ventura-bike.com) Internet: [www.ventura-bike.com](http://www.ventura-bike.com)**